

---

**Dimensions**

---

Product dimensions (mm)	150 x 150 x 900
-------------------------	-----------------

---



---

**Scheme**

---

Scheme

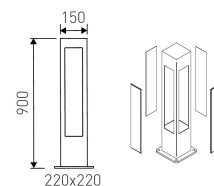



---

### Minimalist bollard from the TROLL family Kubik Pole Soft.

---

**DESCRIPTION**

Type of product - for outdoor uses. The way of mounting - free-standing luminaire. Luminaire housing made of aluminum profile, coated with facade powder paint resistant to UV. Housing colour - anthracite (RAL 7016). Luminaire dimensions: length - 150 mm, width - 150 mm, height - 900 mm. Optical system - PMMA opalized diffuser. Luminaire is equipped with light source. Types of light sources - LED. Printed circuit board for mounting LED made of ceramics. Luminous flux of LED sources - 3505 lm. LED sources power - 25 W. Colour temperature of light source - 4000K. SDCM=2. CRI>85. Durability of LED light sources - 76000 h (L90/B10). Luminous flux of the luminaire - 1174 lm. Power consumed by the luminaire - 28 W. Luminous efficacy of the luminaire - 42 lm/W. Type of power supply - electronic gear. Operational temperature range of the luminaire -25°C to 30°C. Protection level IP - IP65. Protection level IK - IK08. Protection against electric shock - class I. Certificates and admissions - CE. Accessories: foundation.

Item code	0C4K94S30A
Product type	OUT
Category	Bollards
Family	Kubik
Subfamily	Kubik Pole Soft Led
Materials	Luminaire housing made of aluminum profile, coated with facade powder paint resistant to UV.
Optical system	Optical system - PMMA opalized diffuser.
Installation instructions	The way of mounting - free-standing luminaire.
Pictograms	 

---

**Product**

---

Real power (W)	28
Real luminous flux (Lm)	1174
Luminous efficiency (Lm/W)	42
Life time (h)	76000 (L90/B10)
IP	65
IK	08
Electrical class insulation	Class 1
Operating temperature	from -25°C to 30°C
Electrical feeding	220..240V, 50/60Hz
Colour	Anthracite
Energy efficiency class	A
Diffuser	PMMA opal diffuser

---

**Control gear**

---

Control gear included	Yes
Control gear	Electronic Control Gear
Factor de potencia	0,9

---

**Light source**

---

Light source included	Yes
Light source	LED
Nominal power (W)	25
Nominal luminous flux (Lm)	3505
Average life time (h)	76000
Colour temperature (K)	4000
Colour consistency (SDCM)	2
CRI	85

---

**Accessories**

---

AG2TJ5782-3	SUBSTRUCTURE 5782-3 RAL9007
-------------	-----------------------------

---

Scheme

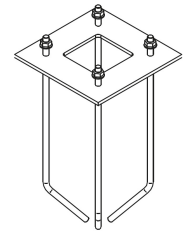

---

AG2TJ5782-4

SUBSTRUCTURE 5782-4

---

Scheme

